

DESCRIPTION:

PT61 float and thermostatic (integral air vent) steam traps are designed for draining condensate from all types of low and medium pressure steam heating and process equipment.

Typical applications include unit heaters, heat exchangers, driers and jacketed vessels.

AVAILABLE TYPES:

PT61 - with Thermostatic Air Vent

PT61S - with Steam Lock Release (SLR)

FEATURES:

Modulating discharge.

Discharges condensate at steam temperature.

Excellent air venting (by thermostatic air vent).

USE: Saturated and superheated steam

SIZES: DN15, 20, 25

CONNECTIONS: Screwed (NPT/BSPT/BSP)

LIMITING CONDITIONS:

PMA: Max. allowable pressure	16 bar(g)
TMA: Max. allowable temperature	220 °C
PMO: Max. operating pressure	14 bar(g)
TMO: Max. operating temperature	220 °C
Cold hydro test pressure	32 bar(g)



INSTALLATION:

Standard horizontal installation with flow from right to left PT61.

UPON REQUEST:

- Horizontal installation with flow from left to right PT61 (L-R)
- Vertical installation with flow from top to bottom PT61(V).

Max. differential pressure range:

PT61-4.5 : 4.5 bar

PT61-10 : 10 bar

PT61-14 : 14 bar

The trap should be installed below the drain point of the equipment in a position so that the float arm is in a horizontal plane and the float rises and falls vertically, with the flow direction as indicated on the body.

The arrow on the nameplate should be pointing vertically upwards.

TRAP DISCHARGE CAPACITY IN kg/hr

MODEL	SIZE	DIFFERENTIAL PRESSURE (bar)																
		0.5	1	1.5	2	3	4	4.5	5	6	7	8	9	10	11	12	13	14
PT61 -4.5	DN15,20	200	280	320	350	400	454	495	-----	-----	-----	-----	-----	-----	-----	-----	-----	-----
PT61 -4.5	DN25	530	700	750	879	1019	1099	1229	-----	-----	-----	-----	-----	-----	-----	-----	-----	-----
PT61-10	DN15,20	135	150	165	180	210	241	255	280	300	350	391	405	420	-----	-----	-----	-----
PT61-10	DN25	230	320	370	420	510	570	600	640	680	710	760	800	820	-----	-----	-----	-----
PT61-14	DN15,20	125	140	150	165	190	221	230	246	271	296	325	350	375	404	430	454	482
PT61-14	DN25	130	160	180	220	260	300	320	330	360	380	400	430	450	460	475	490	510

Recommended safety factor: steady condns. 1.5 - 2; fluctuating condns. 2-3

MATERIAL:

No.	PART	MATERIAL	QTY.(Nos.)
1.	BODY	CAST IRON	01
2.	COVER	CAST IRON	01
3.	GASKET	CAF / Non CAF	01
4.	VALVE SEAT	13% CR STEEL / AISI 410/420	01
5.	BALL FLOAT & LEVER ASSY.	AISI 304	01
6.	AIR VENT ASSY.	STAINLESS STEEL	01
7.	BOLT	HIGH TENSILE	04
8.	BRACKET ASSY.	AISI 304	01
9.	DRAIN PLUG	CARBON STEEL	01
10.	GASKET	COPPER	01
11.	SLR UNIT	AISI 304	01
12.	SPRING	STAINLESS STEEL*	01

* Only for DN25 size (Not shown in view)

DIMENSIONS - Nominal in mm

SIZE	A	B	C	D	Wt.
DN15,20	130	146	62	110	3.3 kg
DN25	145	162	59	110	4.3 kg

AVAILABLE SPARES:

Valve Seat, Ball Float & Lever Assy., Air Vent, Gaskets.

HOW TO ORDER:

PT61-4.5 DN20 BSP

ORDERING INFORMATION:

- 1) Inlet Pressure in bar (g)
- 2) Back Pressure in bar (g)
- 3) Operating Temperature in °C
- 4) Condensate Load in kg/hr
- 5) Size & Model
- 6) Horizontal / Vertical
- 7) End Connections.

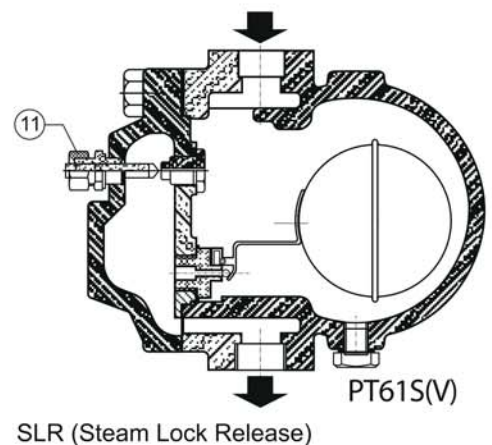
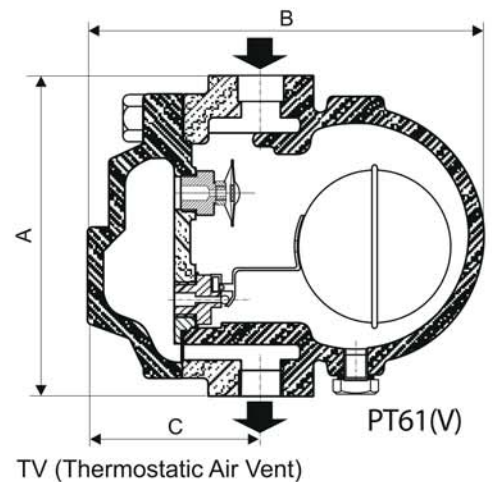
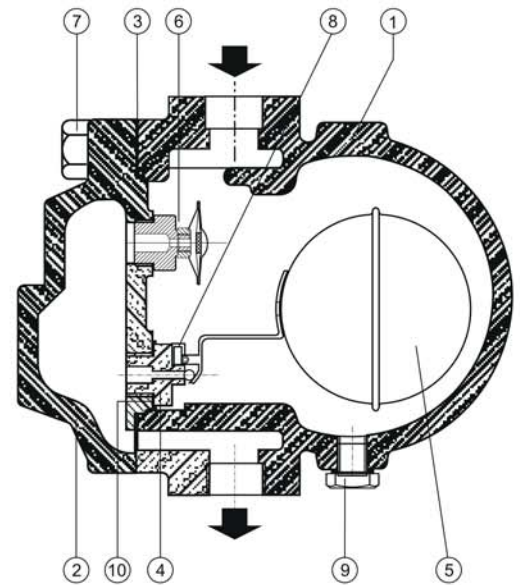
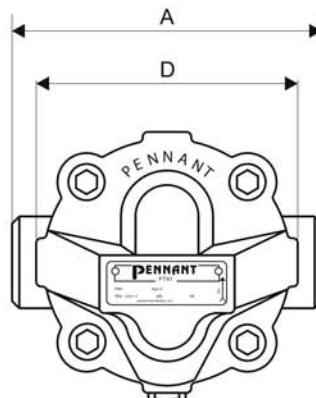

Local regulations may restrict the use of this product below the conditions quoted. Limiting conditions refer to standard connections only. In the interest of development and improvement of the product, we reserve the right to change the specifications without prior notice.